

Ravenscourt Park Wildlife Garden

“There is nothing else in magic but the wild thought of the bird as it casts itself into the void..

Where the harum-scarum magic of small wild creatures meets the magic of Man, where the language of the wind and the rain and the trees can be understood, there we will find the Raven King.”

— *Susanna Clarke, Jonathan Strange & Mr Norrell*





The Wildlife Area is located between the playground and the northern border of the park along Goldhawk Road. It is a mixture of woodland with a meadow and pond, and has developed an interesting character out of remnants of old gardens, habitat creation projects and being allowed to grow wild. There are some magnificent trees and views and flourishing wildlife.

It deserves to be a well-loved sanctuary and space to observe and enjoy the natural world, play imaginative games and enjoy the healing presence of nature.

Aims

- To protect and enhance wildlife habitats and plant and animal biodiversity
- To improve the appearance by cleaning up litter, using a design approach to managing the vegetation, introduce more native plants for flowers, berries, foliage and structure
- To gather and mobilise community love, support and volunteer assistance for the wildlife area
- To practise sustainable, wildlife-enhancing and climate-resilient management to fulfill the ambitions of the Ravenscourt Park Management Plan.

Approach

- Allow wildness and natural ecological processes to dominate - if in doubt, do nothing.
- Positive environmental impact - sustainable materials, soil carbon regeneration
- Introduce more native edible plants and fungi such as berries and herbs to benefit birds and insects

Example actions

- Create a mound and drystone rockery facing the gate and replace nettles and docks with calendula, teasel, scabious, burnet, mullein, wild thyme and other attractive wildflowers



- Orchard trees and shrubby thickets : Lightly prune trees to create structural diversity and enhance ground layer with fruiting and herbaceous plants - Guelder rose, foxgloves, currants, columbines.



- Woodland - enhance soil in dry shady areas and introduce ferns and fungi, remove some non-native plants and improve structural diversity by pruning some trees and shrubs
- Clean and restore pond. Restore bog area and plant with ragged robin, meadowsweet, willowherb and other attractive pond plants



- Trim hedge to restore dense, neater shape and introduce dense ground layer planting to help screen Goldhawk road traffic.
- Improve floral diversity in the meadow with appropriate weeding and mowing and introducing wildflower plugs



habitat plan

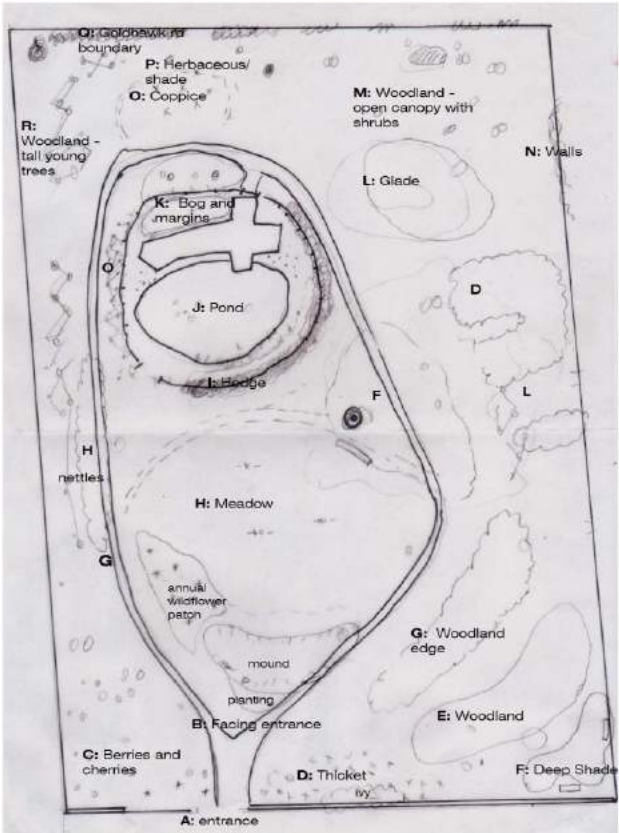

moodboard



References and Background

[Ravenscourt Park Management Plan 2012-2022](#)

[Report of the Hammersmith and Fulham Biodiversity Commission 2017](#)

Prepared by

Jennifer O'Riley

jenmtoriley@yahoo.com
jensgardenservice.co.uk